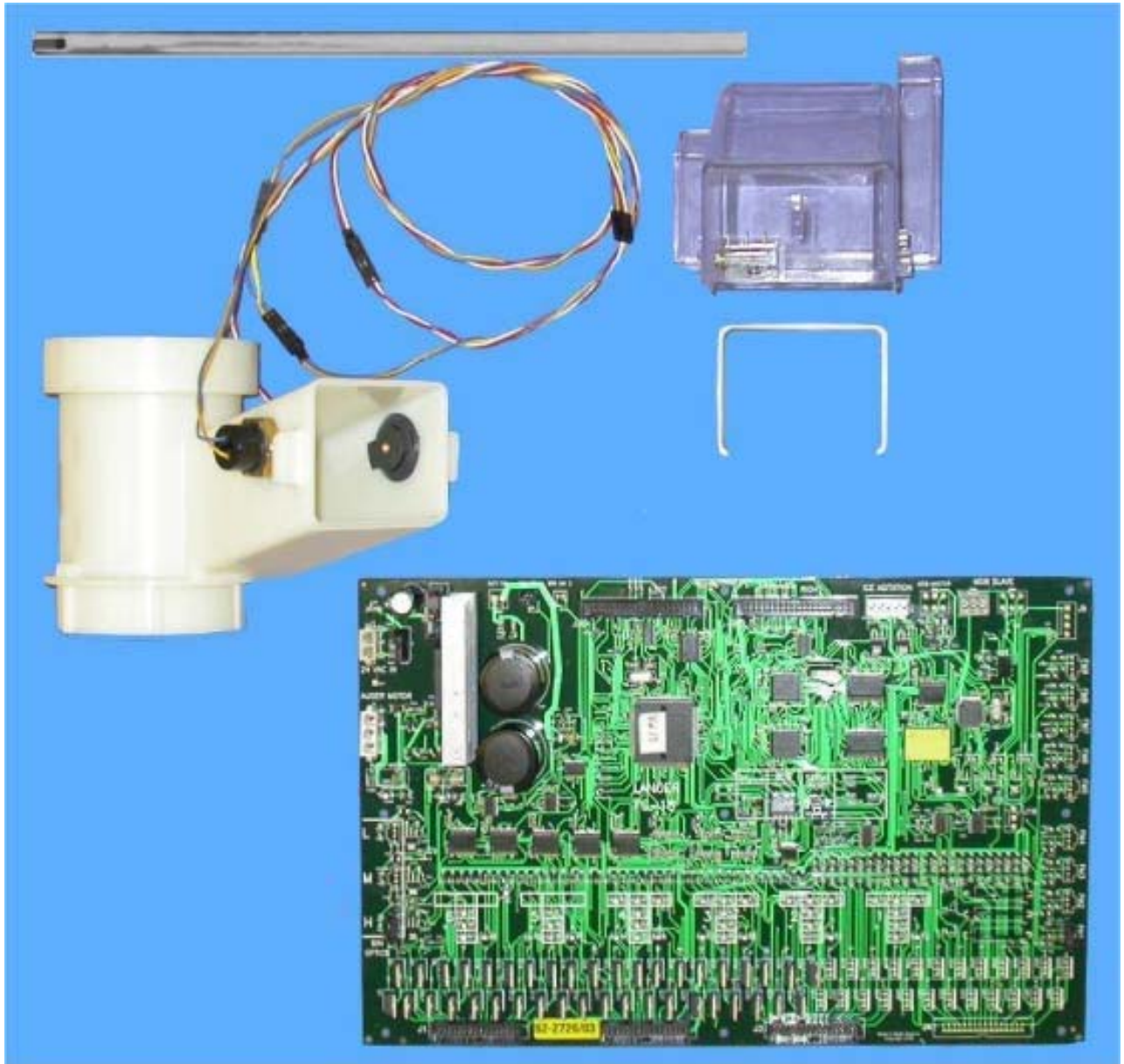


# INSTRUCTION SHEET

## FS 18 FIELD RETROFIT KIT - 82-3901

### INSTALLATION INSTRUCTIONS

---



---

Parts List:	PCB Assy, FS18, CPU	PN-52-2729/04
	Ice Chute Adapter w/ optics	(See Figure 19)
	Chute, Slotted	PN-05-0925-01
	Seal, Ice Chute	PN-02-0612
	Tube, Probe, Direct Drop	PN 47-3456/01

---

**LANCER**

6655 LANCER BLVD. • SAN ANTONIO, TEXAS 78219 USA • (210) 310-7000

FAX SALES

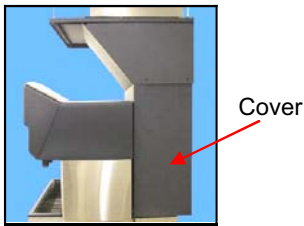
• NORTH AMERICA – 210-310-7245 • INTERNATIONAL SALES – 210-310-7242 • CUSTOMER SERVICE – 210-310-7242 •  
• LATIN AMERICA – 210-310-7245 • EUROPE – 32-2-755-2399 • PACIFIC – 61-8-8268-1978 •

• FAX ENGINEERING: • 210-310-7096 •

• "Lancer" is the registered trademark of Lancer •  
• Copyright — 2006 by Lancer, all rights reserved •

DATE:	01/24/07
P.N.	28-0713

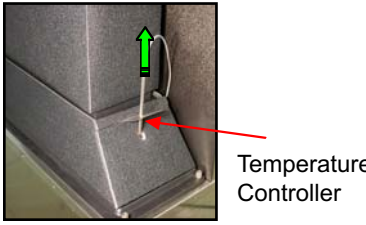
**WARNING:**  
**WHEN UNIT IS BEING SERVICED, CLEANED, OR SANITIZED, UNPLUG UNIT FROM POWER SOURCE.**



**Figure 1**

**1. Detach Direct Drop assembly from unit and pull into open,**

- A. Remove “Direct Drop” cover.(**Figure 1**)
- B. Remove temperature controller by pulling up out of bracket.(**Figure 2**)
- C. Remove lower chute assembly from top rear of unit. (**Figure 3**)
- D. Roll unit Forward.

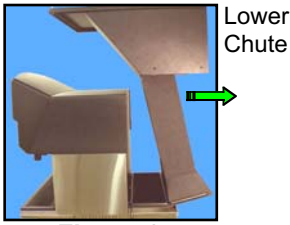


**Figure 2**

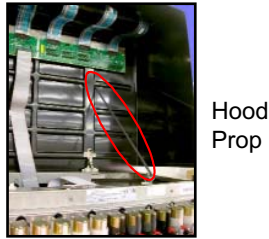
**2. Raise the hood 90 degrees for access to Main Electronics Board and Ice Chute Adapter. (Figure 4)**

**NOTE:** If the hood cannot be propped up fully opened (90 degrees) then remove the hood.

- 1. Loosen the top screws located near the key hole on the hood hinges.
- 2. Remove the hood by sliding the hood upward allowing the loosened screw heads to slip through the key holes on the hinges. (**Figure 5**)

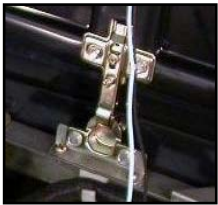


**Figure 3**



**Figure 4**

- A. Disconnect the two touch pad ribbons from the Main Electronics Board. (**Figure 6**)
- B. Disconnect the Ice Chute Harness From The Touch Pad Electronics Board.



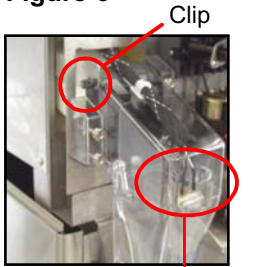
**Figure 5**

**3. Remove Ice Chute Adapter and Install Ice Chute Adapter with Optics**

- A. Remove the Ice Chute by disconnecting the wiring to the Ice Chute Switch, removing the clip for the lever arm, and removing the four Thumb Nuts. Remove lower chute from assembly and set aside. (**Figure 7**)



**Figure 6**

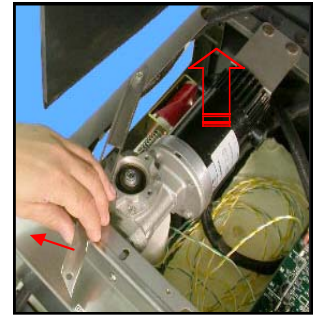


**Figure 7**

- B. Remove Auger Motor Bracket Thumb Screw and rotate the Auger Motor Bracket out of the way. **(Figure 8)**

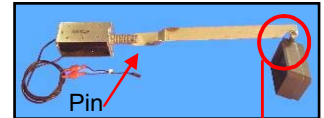
- C. Remove auger Motor by pulling Auger Motor upwards.

**Caution:** A second person should hold the Auger Tube while the Motor is being pulled so that Auger Tube does not twist or pull up with the motor.



**Figure 8**

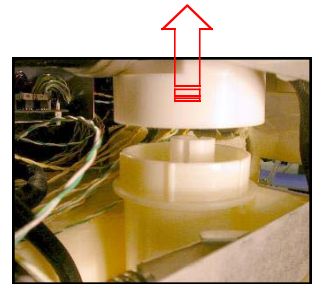
- D. Remove the Solenoid Lever Arm from the Ice Door Lever to the solenoid by pushing the spring towards the solenoid body and pushing the connecting pin out of the assembly. **(Figure 9).**



**Figure 9** Lever Arm

- E. Remove the Ice Chute Adapter

**Caution:** A second person should hold the Auger Tube while the Ice Chute Adapter is being pulled so that the Auger Tube does not twist or pull up with the Ice Chute Adapter. **(Figure 10)**



**Figure 10**

- F. Install the Ice Chute Adapter with the Optic Sensors contained in the kit. **(Figure 11)**

**NOTE:** A piece of electrical tape should be placed over the sharp sheet metal edge of the frame located near the Ice Door Lever where the optics electrical wiring could rub.

- G. Reinstall the Auger Motor.

- H. Reposition the Auger Motor Bracket and install the Thumb Screw.



**Figure 11**

#### 4. Install the new Main Electronics Board.

- A. Disconnect wiring Harness from the Main Electronics Board and note their locations. **(Figure 12)**

- B. Using needle nose pliers remove the Main Electronics Board by squeezing together the catches on the nine standoffs that secure the board to the base plate.



**Figure 12**

**NOTE:** The removed board must be returned to Lancer.

- C. Install the new Main Electronics Board contained in the kit.
- D. Remove the circuit breaker from the old board, and install on the new board..(Figure 13)

Circuit Breaker



Figure 13

**5. Install the Ice Chute Gasket and Ice Chute with slotted holes. This item is contained in the kit.**

- A. Peel backing and install the Ice chute Gasket onto the gray Ice Door housing (Figure 14)

**NOTE:** The gasket is provided to prevent water leaks due to ice melt. the gasket should seal on both sides and bottom of the interface between the Ice Chute Adapter and the gray Ice Door Housing.

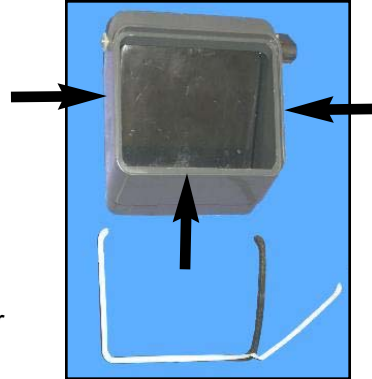


Figure 14

- B. Install the Ice Chute with the four Thumb Screws.

**NOTE:** Ensure that the Ice Chute and Ice Door Housing are installed correctly by feeling for a step between the Ice Door housing and the Ice Chute Adapter. There should not be a ridge that would catch ice as it falls through the opening.

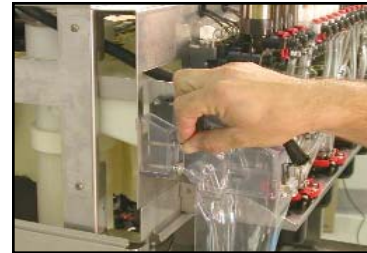


Figure 15

- C. Install the Lower Ice Chute by attaching the ears to the pegs on the top portion of the Ice chute..

**NOTE:** The ears have a slight chamfer on top to help guide the ears over the pegs. Install using an upward motion to get the ears to flex outward over the bosses.



Figure 16

- D. Reattach the return spring located on the front face of the Ice Chute assembly.

- E. Connect the Optics Wiring Harness to the Electronics Board connector labeled H just above the BIN OPTICS label. (Figure 17)



Figure 17

**6. Roll the unit back into position and reinstall the “Direct Drop” cover.**

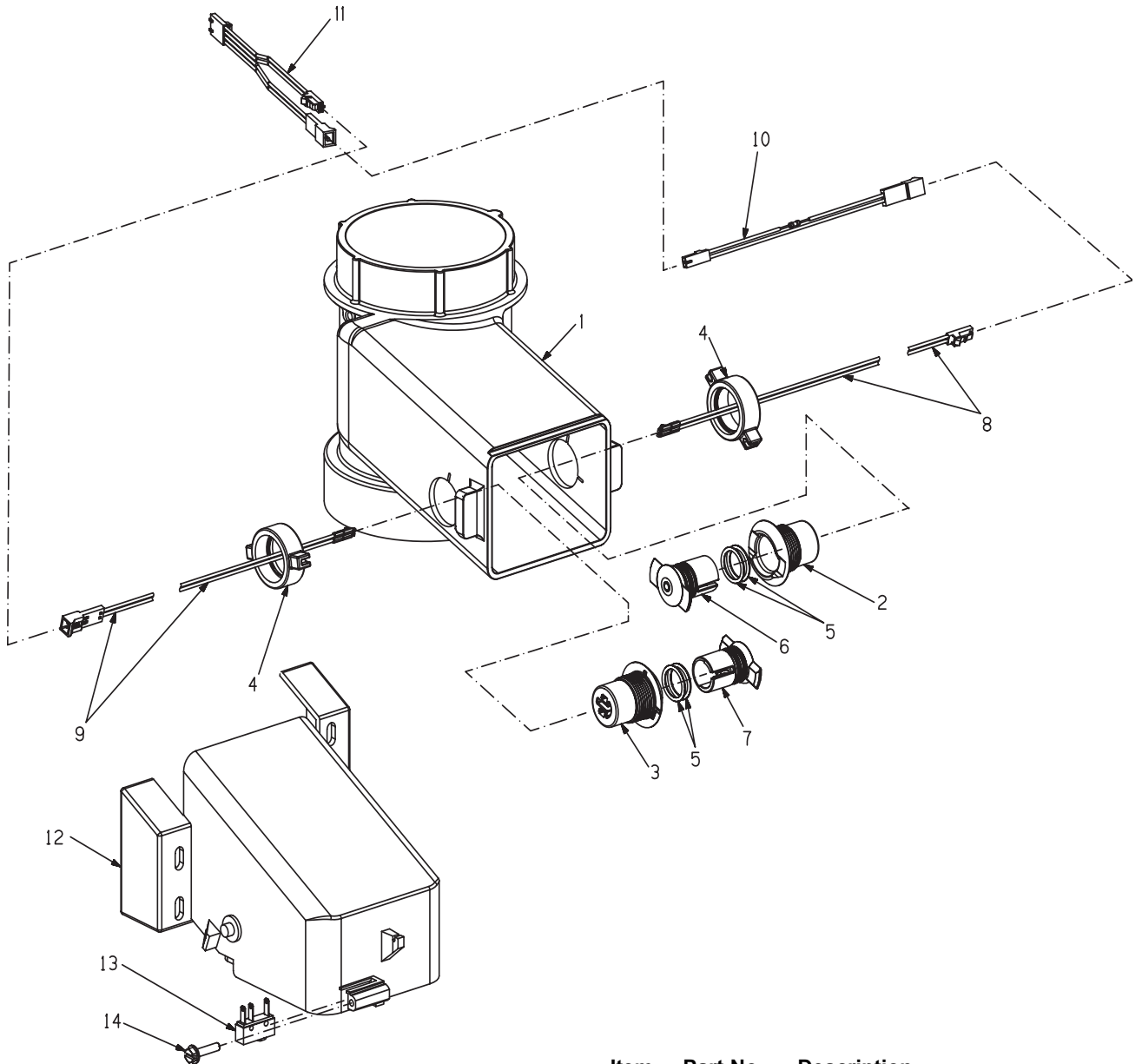
**7. Position the temperature controller inside the longer Bin Stat Tube provided in the kit and install. (Figure 18)**

**8. Reconnect the power.**



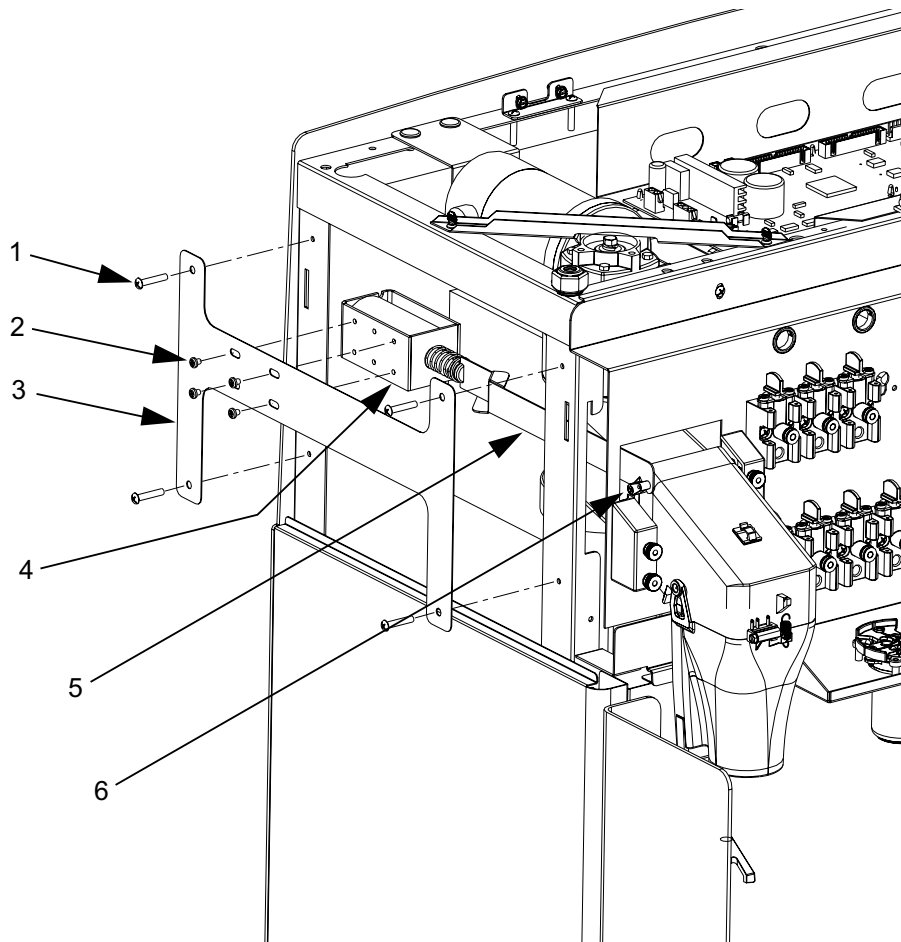
Figure 18

**Figure 19 - Exploded View of Ice Chute Optics Kit**



Item	Part No.	Description
1	05-1834-01	Adapter, Chute, MB-18 w/Optics
2	05-1839	Housing, Emitter, Sensor
3	05-1841	Housing, Detector, Sensor
4	05-2518	Nut, 7/8-20 UNEF, PL
5	02-0155	O-Ring
6	52-2352	Body, Emitter, Sensor
7	52-2353	Body, Detector, Sensor
8	52-2449/01	Harness Assy, Emitter
9	52-2450/01	Harness Assy, Detector
10	52-3097	Harness, FS18, Ice Chute, Emit Adapter
11	52-1499/01	Harness Assy, Wye, Ice Level Sensor
12	05-0925-01	Chute, IBD, Slotted
13	12-0244	Switch, SPST
14	04-0268	Screw, 6-19 x .625

**Figure 20 - Solenoid Assembly, Ice Door, FS-18**



<b>Item</b>	<b>Part No.</b>	<b>Description</b>
1	04-1089	Screw, 10 - 32 x 1.000
2	04-0320	Screw, 8 - 32 x 0.187
3	30-9263	Bracket, Mount, Solenoid
4	12-0195	Solenoid, D-90, 32VDC
-	23-1029	Plunger Assy
-	03-0110	Spring, Solenoid
-	04-0328	Washer, Flat, Neoprene
-	04-0327	Washer, Flat, 0.060T x 0.195 ID x 0.439 OD
-	03-0086	Ring, Retaining, #5304
-	10-0496	Pin, Solenoid
5	30-9264	Arm, Lever, Solenoid
6	05-0546	Lever, Door, IBD
-	03-0113	Ring, Retaining, 5114-12
-	03-0205	Ring, #5304-25-H