

Introduction

In a standard TouchPoint unit, there is a sensor located on the front of the unit's splash plate. This sensor recognizes when a customer is approaching the unit and activates the unit's home screen. In an attempt to increase the versatility of the existing sensor and to replace broken or malfunctioning sensors, the following are instructions on how to replace the existing or broken sensor with an updated version.

Contents

<u>Part Number</u>	<u>Description</u>
82-4826	KIT,HOUSING,LENS,POSITION, SENSOR,TP
05-3097	HOUSING,POSITION SENSOR,TP
12-0130	LENS,POSITION SENSOR, TP
04-0571	SCR,4-20X.375,PHD,PH,PLT,ST

Installation

1. Remove the ice dispense lever from the front of the unit.

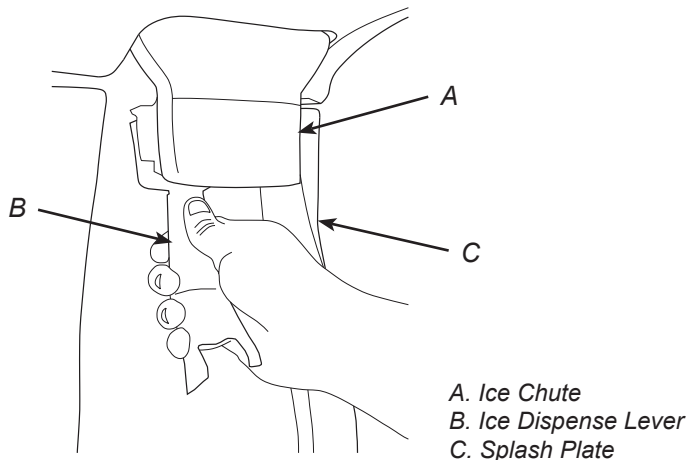

2. Remove the splash plate by lifting up and sliding out.

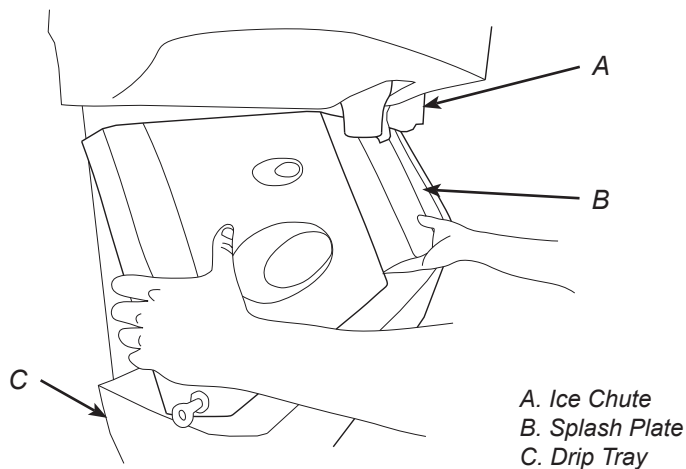

3. Once splash plate is disconnected, unplug the wire harness plugged into the back of the splash plate.

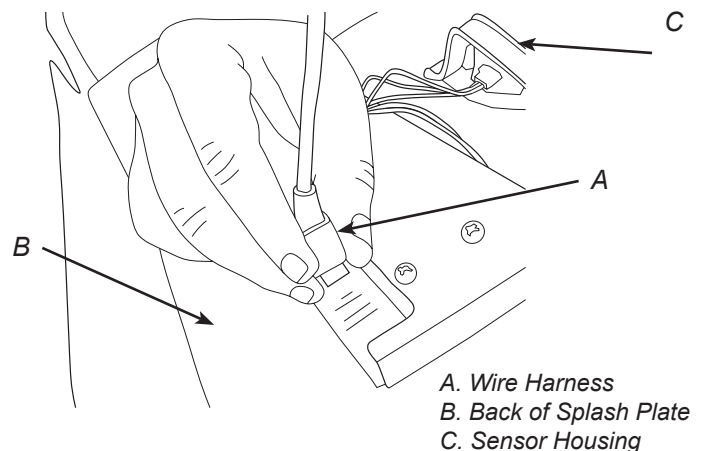

4. Using a screwdriver, remove the two (2) screws connecting the sensor housing and lens to the splash plate.

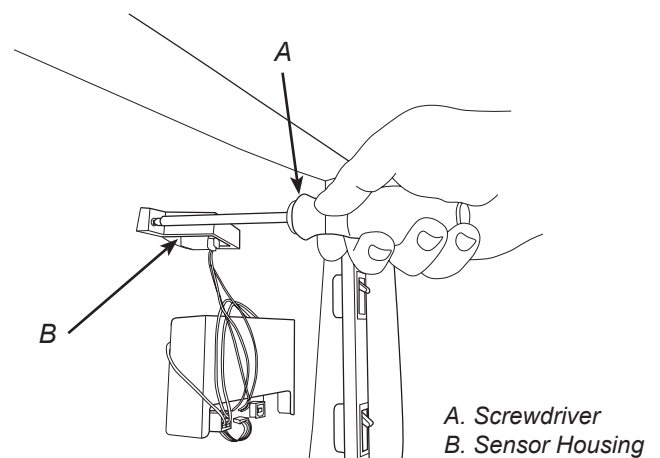

CONTINUED ON NEXT PAGE.....

- Using screws provided, attach new lens and existing sensor housing to unit splash plate.

NOTE

Make sure to attach lens housing and sensor housing using the correct orientation. The sensor housing behind the splash plate should be orientated with the plug and cord routing downward and the sensor facing towards the center of the splash plate. The lens housing should mimic the orientation of the ADA selection buttons on the front of the splash plate. See graphics in instruction sheet for reference.

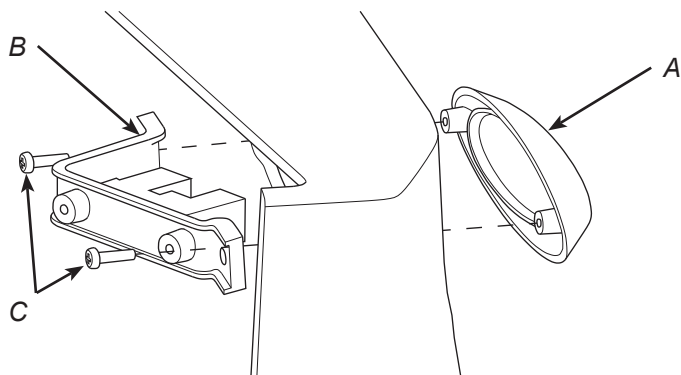

A. Lens Housing
B. Sensor Housing
C. Screws

- Once the new lens housing and existing sensor housing are attached to the splash plate, reconnect wire harness to the back of the splash plate and reinstall to unit.
- Reinstall ice dispense lever and reconnect power.

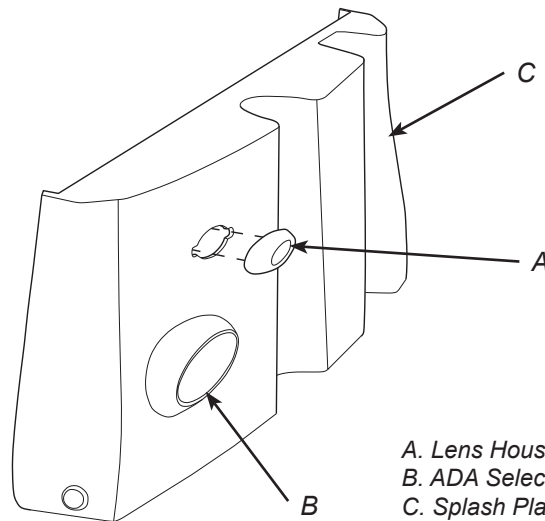

A. Lens Housing
B. ADA Selection Buttons
C. Splash Plate

NOTE

Please refer to the Lancer website (lancercorp.com) for more information relating to Lancer Installation and Operation Manuals, Instructions Sheets, Technical Bulletins, etc.

Lancer Corp., 6655 Lancer Blvd., San Antonio, Texas 78219

800-729-1500 - Technical Support/Warranty: 800-729-1550

custserv@lancercorp.com - lancercorp.com

Manual PN: 28-2847 - January 2015

"Lancer" is the registered trademark of Lancer © 2015 by Lancer, all rights reserved.